

门窗组件





**New!**



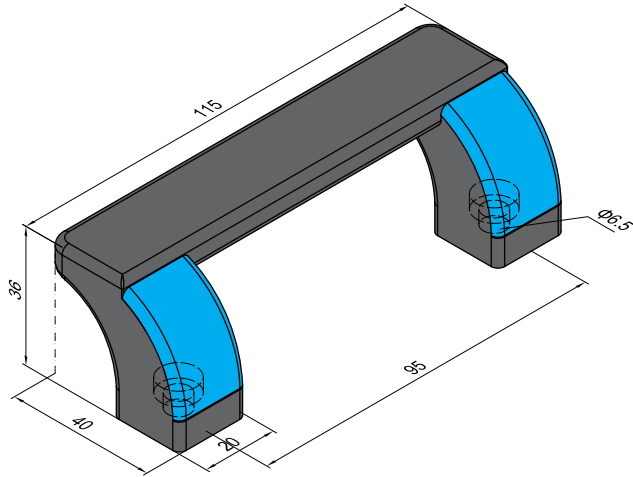
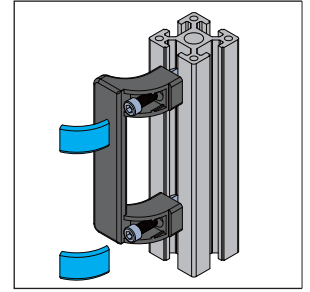



带翼把手

材质和颜色: 尼龙6 黑色

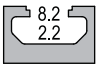
扣盖颜色: 蓝色BE/黑色BK



CP	紧固件	CQ	紧固件
	M6x12 螺栓 碳钢镀锌		M6x16 螺栓 碳钢镀锌
	M6 T 形螺母 碳钢镀锌		M6 T 形螺母 碳钢镀锌

应用	产品描述	紧固组件	扣盖颜色	重量(g)	订购编号
30系列型材 	带翼把手-95 (单个供货)			70	7.12.95.08.BE
	带翼把手-95 (成套供货)	2xCP		88	7.12.95.08.BE.ST
	带翼把手-95 (单个供货)			70	7.12.95.08.BK
	带翼把手-95 (成套供货)	2xCP		88	7.12.95.08.BK.ST
40/45/50/60系列型材 	带翼把手-95 (单个供货)			70	7.12.95.10.BE
	带翼把手-95 (成套供货)	2xCQ		96	7.12.95.10.BE.ST
	带翼把手-95 (单个供货)			70	7.12.95.10.BK
	带翼把手-95 (成套供货)	2xCQ		96	7.12.95.10.BK.ST