

Strut Profile PG20

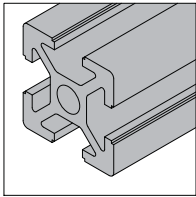

PG20 20x20 4 slots

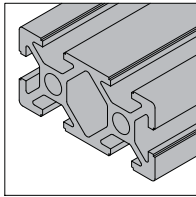

PG20 20x40 6 slots

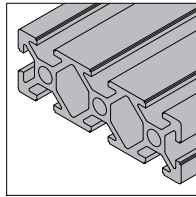

PG20 20x60 8 slots

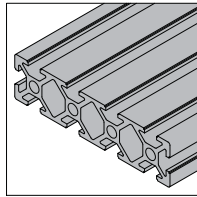

PG20 20x80 10 slots

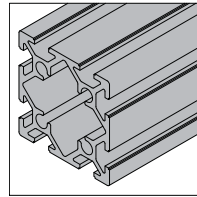

PG20 40x40 8 slots

Strut profile PG20 featuring 6mm T-slot is designed for constructing light weight assemblies such as precision frame structures, showcase etc. Connector selection: die cast bracket, angle profile bracket, inner bracket, linear bar connector etc.

Strut Profile PG20

PG20 20x20 4 slots

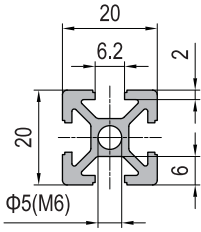

PG20 20x40 6 slots

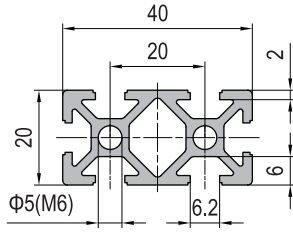

PG20 20x60 8 slots

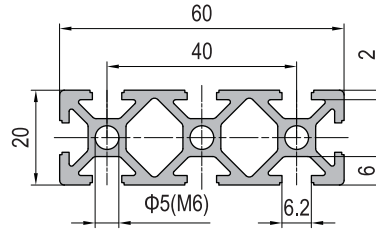

PG20 40x40 8 slots

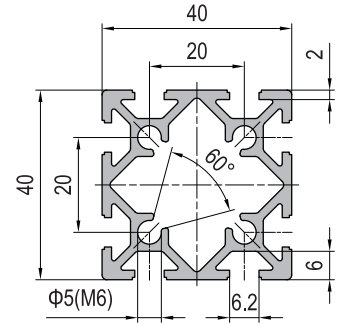

PG20 20x80 10 slots

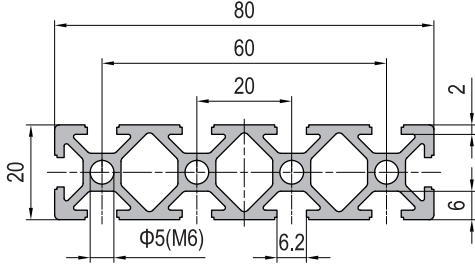

Description	Moment of Inertia Ix(cm <sup>4</sup> )	Moment of Inertia Iy(cm <sup>4</sup> )	Moment of Resistance Wx(cm <sup>3</sup> )	Moment of Resistance Wy(cm <sup>3</sup> )	Mass (kg/m)	Part No.
Strut Profile PG20 20x20 4 slots	0.8	0.8	0.8	0.8	0.5	1.11.20.020020.04
Strut Profile PG20 20x40 6 slots	1.4	5.1	1.4	2.5	0.9	1.11.20.020040.06
Strut Profile PG20 20x60 8 slots	2.0	15.8	2.0	5.3	1.3	1.11.20.020060.08
Strut Profile PG20 20x80 10 slots	2.6	35.9	2.6	9.0	1.7	1.11.20.020080.10
Strut Profile PG20 40x40 8 slots	8.9	8.9	4.5	4.5	1.3	1.11.20.040040.08